

## Instruction for Countertop Reverse Osmosis Water Purification System

This Reverse Osmosis System produces 1 gallon of water every 15-26 min. (very slow, water purification output depends on membrane Gallons Per Day rating, water is dripping not flowing). RO membrane splits water with 0.0005-micron filtration, approx. 1000 times more effective than any water filter without membrane. We highly recommend collecting water in advance (every day or every second day) to always have it on hand. Use any kind of water container (glass or plastic). If you need filtered water right away and do not want to wait for the water to be properly filtered, please do not run water through RO System out of curiosity. If RO is used even once it may not be resold anymore (only recycled).

### Please do the following before using the system for the first time.

1. RO system connects directly to standard kitchen faucets. Standard adapter fits approx 90% of all standard types of faucets. For some rare faucets, we carry different size adapters. Other connections with various types of adapters: bathroom faucets, pulldown/sprinkler type faucets, garden or laundry outlet, shower arm connection, handheld shower adapter. Please contact Customer Care if you need specific adapter.
2. Use the RO system only with COLD water. Hot water decreases the life of filter cartridges by 5-30 times. Minimum temperature - 40 F, maximum temperature - 90-95 F. Do Not place the RO system under direct sunlight for a long time (20 min or more). Minimum water pressure - 40 psi.
3. Flush RO system for 20-30 minutes during first use.
4. All RO systems (not only ours) split water onto pure and wastewater lines. The ratio for pure and wastewater is 1 to 2.5. You can collect and reuse wastewater for watering plants, car wash, or technical needs.
5. Replace filters every 8-12 months (12 months for a family of 1-2 members; 8 months - for a family of 3-5 members).
6. We recommend storing drinking water in a glass or food-grade container(s). Water stays fresh for a few days (up to a week) if you store purified water inside the fridge. We recommend using water within 24-48 hours if the container stores at room temperature.

4 and 5-Stage RO SYSTEM DIAGRAM

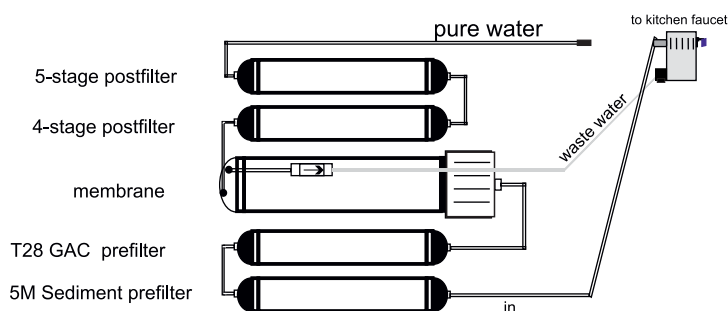

### The Quick Connector Connect / Disconnect Quick View

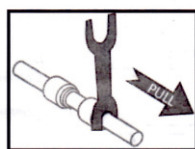
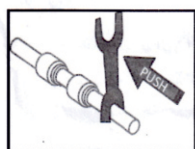

#### To connect standard quick push-in fittings:

- (1) If there is a blue C ring on it, remove it first.
- (2) Insert tube all the way into the socket.
- (3) Pull the tube to check security.

#### To disconnect standard quick push-in fittings:

- (1) If there is a blue C ring on it, remove it first.
- (2) Push in the collet, at the same time,

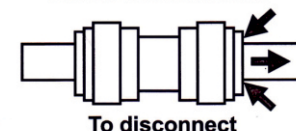
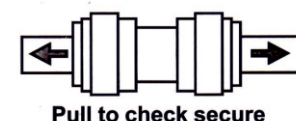
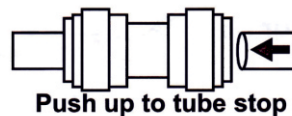

**Package Content:**

- Reverse Osmosis RO System with preinstalled membrane.
- Chrome Metal water diverter.
- Kitchen adapter for female type of spout.

**First Use.**

1. Remove the RO system out of the package, remove the plastic wrap (recommended).
2. All modern kitchen faucets have an aerator at the end of the spout. Remove it use fingers. If the aerator is stuck, use pliers to unscrew the aerator (place some cloth pieces around the aerator to prevent the aerator from scratches).
3. Check if a yellow or black o-ring is inside the diverter. In some cases, the o-ring may fall off the diverter. Using a diverter without o-ring causes a 100% leak. If necessary, install an adapter first (for spouts with female threads, for the faucet spouts with male threads - screw diverter onto the faucet spout without adapter). Do not use Teflon tape. Teflon tape on the connection will cause a 100% leak.
4. Turn the lever on the diverter 90 degrees clockwise (perpendicular water flow). Turn cold water ON. Never use a hot or mix water supply. During first use, it takes 3-4 minutes to get water inside all filters (after the first use, it takes 30-60 seconds to start pure water gets flowing out).
5. Flush RO system for 20-30 minutes during first use. Regular use: start collecting water right away. If you have the RO system with an alkaline post filter, we recommend starting collecting water after 40-60 seconds. The first batch of water may be too alkaline if the filter stays overnight. If you use the RO system occasionally, we recommend starting collecting water after 40-60 seconds.
6. This Reverse Osmosis produces 1 gallon of pure water every 15..26 minutes\* (very slow, water dripping not flowing). Reverse Osmosis Membrane splits water with 0.0005-micron filtration, approximately 1000 times more effective than any water filter without the RO membrane. We highly recommend collecting water in advance (every day, every second day, or less frequently). You can use any type of water container (glass or plastic). If you have a kitchen alarm clock, you can set up an alarm for 5-19 minutes.
7. If you don't plan to use the RO system for 7-10 or more consequence days, disconnect the RO system from the faucet. Place RO system in a cold dark spot with a temperature above 38 F degree (not more than 60 F). The lower shelf in the fridge is the right place (make sure temperature is above freezing point all the time). When you start using the RO system after a long period, flush it for 10-20 minutes before collecting pure water.
8. In case of a leak. Leak at faucet connection. Check:
  - If the o-ring is fallen from the diverter, and the diverter screws onto the spout without the o-ring (100% leak guaranteed). If the adapter is in use, there must be 2 o-rings (spout - o-ring - adapter - o-ring - diverter).
  - If you don't use the adapter, replace the clear o-ring inside the diverter with that black o-ring. Check if the leak persists.
  - Your faucet might need a different size of the adapter. If the diverter wobbles at connection, it means that you need another type of adapter. Please email or contact the manufacturer/seller if the diverter wobbles at the connection. A different adapter is needed.

Leak at elbow connection. Please email or contact us by phone. It takes 2-4 minutes to fix any leaks.

There is no need to ship the RO system back. We have a manual on how to repair any leak. A leak may be caused by rough handling during shipping (rough handling may dislocate tubing inside elbow and cause some minor leak).

**Chrome Metal Diverter**

Picture #1

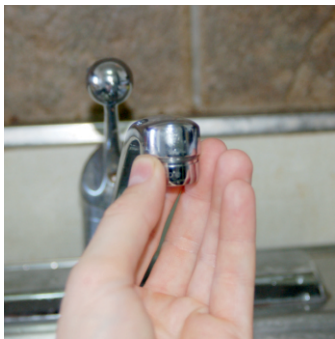

After collecting pure water, you can leave RO system on countertop or unscrew diverter and remove RO system (Picture #1).

Configuration



Another option is to use union fitting to fast connect/disconnect. Union fitting sold separately

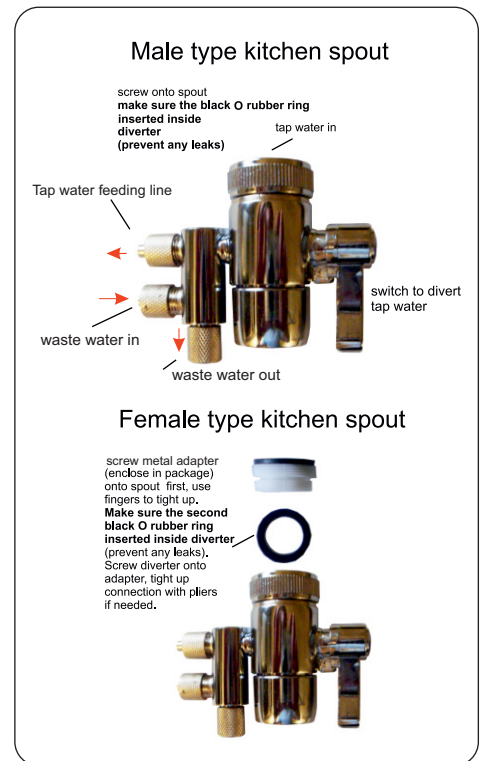

## Replacement filters and assembly.

Visit our website: MyAquaFilter.com (or Ebay Store) for replacement filter sets. Price starts from \$24.99.

Replacement filter sets are available in 2 options:

- single filters (takes approx 35-40 minutes to replace filters)
- “ready to go” assembly (takes 1 minute to connect new assembly)

## Attention California customers regarding using waste water.

Because of drought we highly recommend to collect waste water. Waste water is technical water which can be used in many different ways:

1. Watering plants in the garden. Waste water is pretreated water without chlorine/chloramine. Ideal source for watering plants
2. Refilling toilet tank
3. Using for car wash

## Checking TDS / pH level.

Checking TDS / pH level. RO System comes with brand new carbon filters. During the initial flush, not all carbon dust (completely unharmed) leaves the filter cartridge. A New TDS reading test needs to be taken at least 4-7 days after regular RO use (or over 50 gallons). TDS reading test samples can be taken from diverter if your RO system has T33 post filter, DI or DI/T33 filter. Any mineral/alkaline / calcite / KDF-55 filter cartridge adds some minerals back into water which causes a significant rise in TDS level. To avoid incorrect TDS reading disconnect the membrane stage and the stage right after membrane to collect 2-4 oz water sample. Check TDS reading. Reconnect membrane housing with the next stage back. More details: myaquafilter.com Help Section.

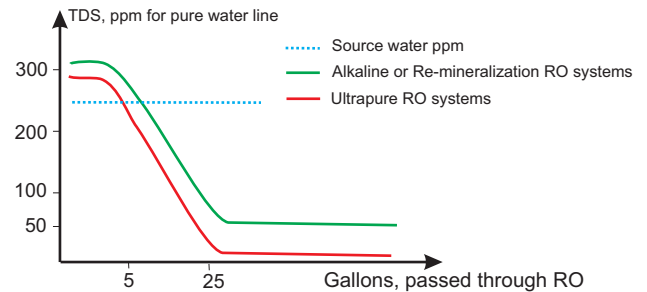

Checking pH level. pH level can be tested by a digital pH meter.

Do NOT use any test strips for pH. Use digital pH meter only.

## ONE YEAR WARRANTY

What your warranty covers.

Reverse Osmosis Systems are warranted to the original owner to be free of defects in material and workmanship from the date of manufacturing for one year as follows:

- Manufacturer will replace within one year of purchase the defected parts (excluding filters) at no charge.
- Replaceable filters are not warranted since the service life of replaceable filter varies with local water conditions and thus not warranted.

Conditions of Warranty:

- System must be maintained and serviced with the manufacturer original replacement parts and filters. Performance of your drinking water system is directly related to conditions of the water been treated and the particular application in which it is used. Therefore, manufacturer's liability is limited to the cost of repair of the RO system
- Manufacturer is not liable for incidental or consequential damages of any kind. Systems must be installed and operated in accordance with manufacture's recommended procedures and guidelines. Filter cartridges come with 30 day manufacturer warranty (against factory defects), membrane - 12 months.

What Reverse Osmosis Systems will not do:

- Warranty is voided if product failure or damage results from freezing, neglect, misapplication, fouling with sediment or scale or failure to operate the system in accordance with the instructions contained in this manual.

The following operating conditions must also be followed for this warranty to be valid:

- Feed water is highly contaminated, source of water unknown, or microbiologically unsafe
- No iron can be present in feed water. Or it should be removed from feed water
- pH of the water must not be lower than 3 or higher than 11
- Feed water Total Dissolved solids TDS should not exceed 1000-1200 ppm
- Feed water temperature should be between 90 F and 45 F or (32C and 5 C)
- This Countertop RO system may not being used with RO tank, separate RO faucet and/or connected to constant water supply (connected via undersink valve). Countertop RO designed to be used with any type faucet or the laundry/garden connection. Countertop RO do not have some special parts which undersink Traditional RO systems do such check valve, auto shut off valve etc.

Obtaining Warranty Service: email us.

Limitations and exclusions:

Manufacturer will not be responsible for any implied warranties, including those of merchantability and fitness for a particular purpose. Manufacturer assumes no liability whatsoever for any incidental and consequential damages, including loss of revenue, loss of time, travel expenses, inconvenience, and any damage caused by the equipment and its failure to function properly.

### Product Specification

System Requirements:

- Working pressure: 35 to 85 psi feed water pressure required, if below 40 psi, a booster pump is needed. We have a RO system with booster pump assembly. If the input pressure is above 80 psi, you MUST put a pressure regulator to reduce the pressure below 85 psi.
- Working temperature: 100 ~ 40 deg. F ( 37 ~ 4 deg. C ), pH range: 3-11
- Max TDS ppm for 4 stage RO system - up to 600 ppm, 5 or 6 Stage RO system - up to 1200-1400 ppm
- If source water has hardness level above 300-350 ppm, we recommend 5 or 6 Stage Countertop RO system over 4 Stage RO system.
- If feed water has iron, rust problem, we recommend putting an iron filter prior to the RO system.